

**CEQA LEAD AGENCY CHECKLIST/CERTIFICATION \*  
TRANSPORTATION INFORMATION FROM A REPORTING OR MONITORING PROGRAM**

**Part 1 - Checklist**

Project Name: \_\_\_\_\_  
 Lead Agency: \_\_\_\_\_  
 Lead Agency Contact (Name, Title, Agency, Address & Phone): \_\_\_\_\_  
 State Clearinghouse (SCH) File #/s: \_\_\_\_\_  
 Document Type/s: \_\_\_\_\_  
 Findings & Approval Date/s: \_\_\_\_\_  
 Project Proponent (Name, Title, Company, Address & Phone): \_\_\_\_\_

For each specific Transportation Related Mitigation Measure associated with this Project, The following information items are included in the attached materials:

Yes	No	
<input type="checkbox"/>	<input type="checkbox"/>	Location/Custodian Of CEQA Documents, Proceedings, Records
<input type="checkbox"/>	<input type="checkbox"/>	Description Of How To Obtain Copies Of Above Documents
<input type="checkbox"/>	<input type="checkbox"/>	Mitigation Measure Name & Identifying Number
<input type="checkbox"/>	<input type="checkbox"/>	Detailed Description of Measure & its Purpose (attach blueprints if necessary)
<input type="checkbox"/>	<input type="checkbox"/>	Measure Location Description, Latitude/Longitude, & Vicinity Map
<input type="checkbox"/>	<input type="checkbox"/>	Location of Impacted State Highway Component (County, Route, Postmile)
<input type="checkbox"/>	<input type="checkbox"/>	Caltrans Encroachment Permit Number (if one was needed)
<input type="checkbox"/>	<input type="checkbox"/>	Copy of Other Agency Permits required for this Measure (if needed)
<input type="checkbox"/>	<input type="checkbox"/>	Completion Criteria (including detailed performance objectives)
<input type="checkbox"/>	<input type="checkbox"/>	Implementation Schedule
<input type="checkbox"/>	<input type="checkbox"/>	Estimated Monetary Value of Completed Measure & % Local Agency Funded
<input type="checkbox"/>	<input type="checkbox"/>	Responsible Contractor (Name, Company, Address & Phone)

*The above project mitigation measures will be implemented as indicated in the adopted reporting or monitoring program, and the California Department of Transportation will be notified upon implementation.*

CEQA Lead Agency \_\_\_\_\_

Date \_\_\_\_\_

**Part 2 - Certification**

*We certify that the agreed upon mitigation measures have been implemented, and all other requirements have been adhered to, in accordance with PRC Sections 21081.6 and 21081.7. Attached: 1. Completion evaluation (including field inspection reports); 2. Photograph of completed measure.*

Signature & Date: \_\_\_\_\_

\_\_\_\_\_

Name: \_\_\_\_\_

\_\_\_\_\_

Title: \_\_\_\_\_  
CEQA Lead Agency

California Department of Transportation

\* This form is to be used by public agencies to submit their mitigation reporting or monitoring programs to the California Department of Transportation (Department) when a CEQA project has been found to have transportation or circulation impacts that are of statewide, regional, or area-wide significance. Copies of this form, and the Department Guidelines developed pursuant to PRC Section 21081.7, can be downloaded from our website ([http://www.dot.ca.gov/bc/tpo/offices/evp/evr\\_guidelines\\_procedure.htm](http://www.dot.ca.gov/bc/tpo/offices/evp/evr_guidelines_procedure.htm)). Completed form with attached materials may be post-mailed, e-mailed, or faxed to the appropriate Department District Planning Office, Attention: Intergovernmental Review (IGR) Coordinator. (Form Version 6/2004)

**LETTER 12: STATE OF CALIFORNIA – DEPARTMENT OF TRANSPORTATION**

**Response to Comment 12-1**

The ramp intersections at I-80/Rocklin Road and I-80/Sierra College Boulevard were included in the project's traffic study and the results were presented in the RDEIR; significant impacts at these ramp intersections were not identified. Information regarding volumes and operations on the I-80 mainline were included in the traffic operations analysis that was conducted in support of the Interstate 80/Sierra College Boulevard interchange reconstruction project. This traffic operations analysis, which assumed a more intense Clover Valley project than currently is being proposed, has been accepted by Caltrans as part of their review and participation in the environmental review process for the I-80/Sierra College Boulevard interchange reconstruction project. Given the project's distance from State Route 65, traffic from the Clover Valley project was not anticipated to significantly impact State Route 65 and thus mainline analysis of that facility was not conducted for this project.

**Response to Comment 12-2**

The project does not propose to move large trees, but proposes tree removal, which is addressed in the Biological Resources chapter of the DEIR in Impacts 4.8I-1, 4.8I-2, 4.8I-9, and 4.8I-16.

Additionally, per CEQA Guidelines section 15086(c), “a responsible agency or other public agency shall only make substantive comments regarding those activities involved in the project that are within an area of expertise of the agency or which are required to be carried out or approved by the responsible agency.” This comment regarding moving trees is not within the purview of the Department of Transportation.

**Response to Comment 12-3**

The project applicant would ensure that all necessary encroachment permits are filed with Caltrans prior to the initiation of any construction activities within State right-of-way.

**Response to Comment 12-4**

The City of Rocklin, the lead agency for the project, will complete and submit the Mitigation Monitoring Certification Checklist to the Department of Transportation as requested.



Arnold  
Schwarzenegger  
Governor

March 3, 2006

David Mohlenbrok  
City of Rocklin  
3970 Rocklin Road  
Rocklin, CA 95677

Subject: Clover Valley Large and Small Lot Tentative Subdivision Maps  
SCH#: 1993122077

Dear David Mohlenbrok:

The State Clearinghouse submitted the above named Draft EIR to selected state agencies for review. On the enclosed Document Details Report please note that the Clearinghouse has listed the state agencies that reviewed your document. The review period closed on March 2, 2006, and the comments from the responding agency (ies) is (are) enclosed. If this comment package is not in order, please notify the State Clearinghouse immediately. Please refer to the project's ten-digit State Clearinghouse number in future correspondence so that we may respond promptly.

Please note that Section 21104(c) of the California Public Resources Code states that:

"A responsible or other public agency shall only make substantive comments regarding those activities involved in a project which are within an area of expertise of the agency or which are required to be carried out or approved by the agency. Those comments shall be supported by specific documentation."

These comments are forwarded for use in preparing your final environmental document. Should you need more information or clarification of the enclosed comments, we recommend that you contact the commenting agency directly.

This letter acknowledges that you have complied with the State Clearinghouse review requirements for draft environmental documents, pursuant to the California Environmental Quality Act. Please contact the State Clearinghouse at (916) 445-0613 if you have any questions regarding the environmental review process.

Sincerely,

Terry Roberts  
Director, State Clearinghouse

Enclosures  
cc: Resources Agency

1400 TENTH STREET P.O. BOX 3044 SACRAMENTO, CALIFORNIA 95812-3044  
TEL (916) 445-0613 FAX (916) 323-3018 www.opr.ca.gov

STATE OF CALIFORNIA

Governor's Office of Planning and Research  
State Clearinghouse and Planning Unit

Letter 13



Sean Walsh  
Director

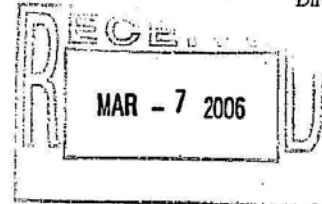

13-1

**Document Details Report  
State Clearinghouse Data Base**

**SCH#** 1993122077  
**Project Title** Clover Valley Large and Small Lot Tentative Subdivision Maps  
**Lead Agency** Rocklin, City of

**Type** EIR Draft EIR  
**Description** A large lot tentative subdivision map to subdivide 622 vacant acres into 33 large lots. The large lots would establish individual units being further subdivided by the proposed small lot tentative subdivision map. The small lot tentative subdivision map would result in 558 single family lots. A General Plan Amendment and Rezone are being requested to address modifications to the open space and residential components of the proposal.

**Lead Agency Contact**

**Name** David Mohlenbrok  
**Agency** City of Rocklin  
**Phone** (916) 625-5160  
**email**  
**Address** 3970 Rocklin Road  
**City** Rocklin  
**Fax**  
**State** CA **Zip** 95677

**Project Location**

**County** Placer  
**City** Rocklin  
**Region**  
**Cross Streets** Sierra College Blvd, Rawhide Rd, Clover Valley Rd, Park Drive, N. Clover Valley Rd, Creekside Ln  
**Parcel No.** 13 parcels  
**Township**

	Range	Section	Base

**Proximity to:**

**Highways** I-80, SR-65  
**Airports**  
**Railways** UPRR  
**Waterways** Clover Valley Creek, Antelope Canal  
**Schools** Valley View ES, Springview School  
**Land Use** Currently vacant / RD-1, RD-1.5, RD-2, RD-2.5, RD-3, RD-4, Comm, Park, OA/LDR, MDR, RC, PQP, R-C

**Project Issues** Aesthetic/Visual; Air Quality; Archaeologic-Historic; Cumulative Effects; Drainage/Absorption; Flood Plain/Flooding; Forest Land/Fire Hazard; Geologic/Seismic; Growth Inducing; Landuse; Minerals; Noise; Population/Housing Balance; Public Services; Recreation/Parks; Schools/Universities; Sewer Capacity; Soil Erosion/Compaction/Grading; Solid Waste; Toxic/Hazardous; Traffic/Circulation; Vegetation; Water Quality; Water Supply; Wetland/Riparian; Wildlife

**Reviewing Agencies** Resources Agency; Regional Water Quality Control Bd., Region 5 (Sacramento); Department of Parks and Recreation; Native American Heritage Commission; Public Utilities Commission; Department of Health Services; Department of Housing and Community Development; Office of Emergency Services; Office of Historic Preservation; Department of Fish and Game, Region 2; Department of Water Resources; California Highway Patrol; Caltrans, District 3; Department of Toxic Substances Control

**Date Received** 01/17/2006      **Start of Review** 01/17/2006      **End of Review** 03/02/2006

Note: Blanks in data fields result from insufficient information provided by lead agency.

**LETTER 13: STATE OF CALIFORNIA – GOVERNOR’S OFFICE OF PLANNING AND RESEARCH, STATE CLEARING HOUSE AND PLANNING UNIT (MARCH 3, 2006)**

**Response to Comment 13-1**

The comment includes a listing of all reviewing state agencies that received the DEIR for the comment period and does not address the adequacy of the EIR.

## Letter 14



Arnold  
Schwarzenegger  
Governor

STATE OF CALIFORNIA  
Governor's Office of Planning and Research  
State Clearinghouse and Planning Unit



Sean Walsh  
Director

### Memorandum

**Date:** March 9, 2006  
**To:** All Reviewing Agencies  
**From:** Scott Morgan, Senior Planner  
**Re:** SCH # 1993122077  
Clover Valley Large and Small Lot Tentative Subdivision Maps

14-1

Pursuant to the attached letter, the Lead Agency has extended the review period for the above referenced project to March 15, 2006 to accommodate the review process. All other project information remains the same.

cc: David Mohlenbrok  
City of Rocklin  
3970 Rocklin Road  
Rocklin, CA 95677

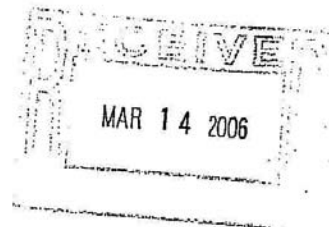

1400 TENTH STREET P.O. BOX 3044 SACRAMENTO, CALIFORNIA 95812-3044  
TEL: (916) 445-0512 FAX: (916) 445-0513

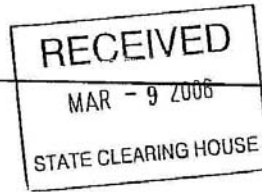

# City of Rocklin

3970 Rocklin Road  
Rocklin, CA 95677-2720  
916-625-5000  
TDD 916-632-4187  
www.ci.rocklin.ca.us

March 7, 2006

To: INTERESTED PERSONS AND AGENCIES:

Subject: SECOND NOTICE OF PUBLIC REVIEW AND AVAILABILITY  
OF A RECIRCULATED DRAFT ENVIRONMENTAL IMPACT REPORT FOR THE  
CLOVER VALLEY SUBDIVISION PROJECT (SCH# 93122077) – EXTENDED  
PUBLIC REVIEW PERIOD

The Rocklin Planning Department is re-announcing the availability of the Recirculated Draft Environmental Impact Report (EIR) for the Clover Valley Subdivision project and has forwarded a Notice of Availability of this document to the following: all agencies and organizations that received the Notice of Preparation, and all persons who own property within 600 feet of the site or have asked to be on the mailing list to receive project information. The State Clearinghouse has also distributed this document to numerous state agencies. The purpose of the Recirculated Draft EIR is to provide sufficient information on the project so that the decision-makers, using this document, can make an informed decision regarding the relative environmental impacts and merits of the project. Reviewers should focus on the comprehensiveness and accuracy of the Recirculated Draft EIR in discussing possible impacts upon the environment and measures that might mitigate adverse impacts.

It has been brought to our attention that Figures 4.12-1 through 4.12-8 that portray the off-site sewer alignment were not included in some copies of the Recirculated EIR. Although the off-site sewer alignment is described in the text of the current EIR on pages 3-13 and 3-14 and pages 4.12-9 and 4.12-10, and is also portrayed in an exhibit on page 3-14, Figures 4.12-1 through 4.12-8 offer a portrayal of the off-site sewer alignment that is broken up onto several exhibit sheets. These exhibit sheets that were intended to be Figures 4.12-1 through 4.12-8 in the Recirculated EIR are now included with this notice. This second notice is also being provided to allow additional time for the public review and comment period.

**Project Description:** The project request is for a Large Lot Tentative Subdivision Map to subdivide 622± vacant acres into 33 large lots. The large lots would establish individual units being further subdivided by the proposed small lot tentative subdivision map. The small lot tentative subdivision map results in 558 single family residential lots. A General Plan Amendment and Rezone are also being requested to address modifications to the open space and residential components of the proposal. The proposed amendments modify some residential lot size and development standards, increase the amount of dedicated open space area and decrease the area for residential development. The amendments will also re-orient the 5.0 acre commercial site. In addition to the proposed land use modifications, a Circulation Element Amendment is proposed for Valley View Parkway to reduce that street from a planned four lanes to two lanes. The project also includes an encroachment into the 50-foot creek setback area along Nature Trail Way at two locations. Implementation of the project would also include the construction of an off-site sewer line to ensure adequate wastewater conveyance is available.

**Project Location:** Clover Valley is located in the northeast corner of the City of Rocklin. The project site consists of 13 parcels, totaling 622 ± vacant acres along the west side of Sierra College Boulevard and the Union Pacific Railroad tracks, two miles north of Interstate 80 and three miles south of State Route 193. Surrounding lands to the south within the City limits of Rocklin include the Summit Property and Clover Valley Woods. Rocklin's Whitney Oaks residential subdivision is located to the west. The subject site's specific location in Rocklin is along the west side of Sierra College Boulevard, north of the terminus of Rawhide Road, and south of North Clover Valley Way/Creekside Lane.

---

Administrative Services 625-5000 FAX 625-5095 – City Hall 625-5560 FAX 625-5561  
Community Development 625-5160 FAX 625-5195 – Engineering 625-5140 FAX 625-5105

*Clover Valley Extended Review Period  
March 7, 2006  
Page 2*

Notice of Public Review: This document is being circulated for an extended public review period. Consequently, comments should be received by the Rocklin Planning Department **NO LATER THAN 5:00 P.M. on WEDNESDAY, MARCH 15, 2006**. This Recirculated Draft EIR and all written comments submitted before the close of the public review period will be incorporated into the Final EIR that is prepared. Notice of Availability of the Final EIR, including all comments and replies, will be sent to those electing to comment on the Recirculated Draft EIR. Therefore, the City requests that all agencies and individuals who comment on this Recirculated Draft EIR keep the document for reference.

For individuals receiving only the Notice of Availability for the Recirculated Draft EIR at this time, a copy of the document is available for public review at the following libraries: Placer County Library at 5460 Fifth Street, Rocklin, and Sierra College Library at 5000 Rocklin Road, Rocklin. In addition, the Draft EIR and all other reference documents are available for review or pick-up at the Rocklin Planning Department during normal business days from 8:00 a.m. to 5:00 p.m. Please send your written comments to Sherri Abbas, Planning Services Manager, 3970 Rocklin Road, Rocklin, CA 95677. We would appreciate the name of the contact person in your organization and/or agency.

**PUBLIC HEARINGS TO CONSIDER CERTIFICATION OF THE ENVIRONMENTAL DOCUMENT AND A DECISION ON THE PROJECT WILL BE SCHEDULED AND NOTICED AS APPROPRIATE IN THE FUTURE.**

Listing of Potential Significant Environmental Effects: As listed in the Recirculated Draft EIR, the project would result in the following significant unavoidable adverse impacts –

- Degradation of the visual character or quality of the project site or off-site areas as a result of construction activities
- Impacts to views from Sierra College Boulevard and in the Loomis area north of the Summit and across Sierra College Boulevard
- Impacts to wooded hillsides (aesthetics)
- Contribution to the cumulative alteration of the overall visual character of the project site
- Contribution to the cumulative light and glare on adjacent sensitive receptors
- Contribution to the cumulative traffic impact at King Road and Sierra College Boulevard
- Impacts related to construction generated pollutants
- Contribution to cumulative air quality impacts
- Impacts related to the loss of oak trees on the project site as a result of project implementation
- Impacts resulting from the conversion of grassland wildlife habitat
- Long-term operational impacts to riparian and aquatic habitats
- Contribution to the cumulative biological impacts to vegetation and wildlife
- Impacts as a result of the alteration of topography

Please contact David Mohlenbrok or myself at (916) 625-5160 if you have any questions regarding the project or the environmental review process.

Sincerely,



Sherri Abbas, ACIP  
Planning Services Manager

E:\planning\Notice\2006\CVL 2006 Notice of DEIR Availability#2.doc



Figure 4.12 – 1

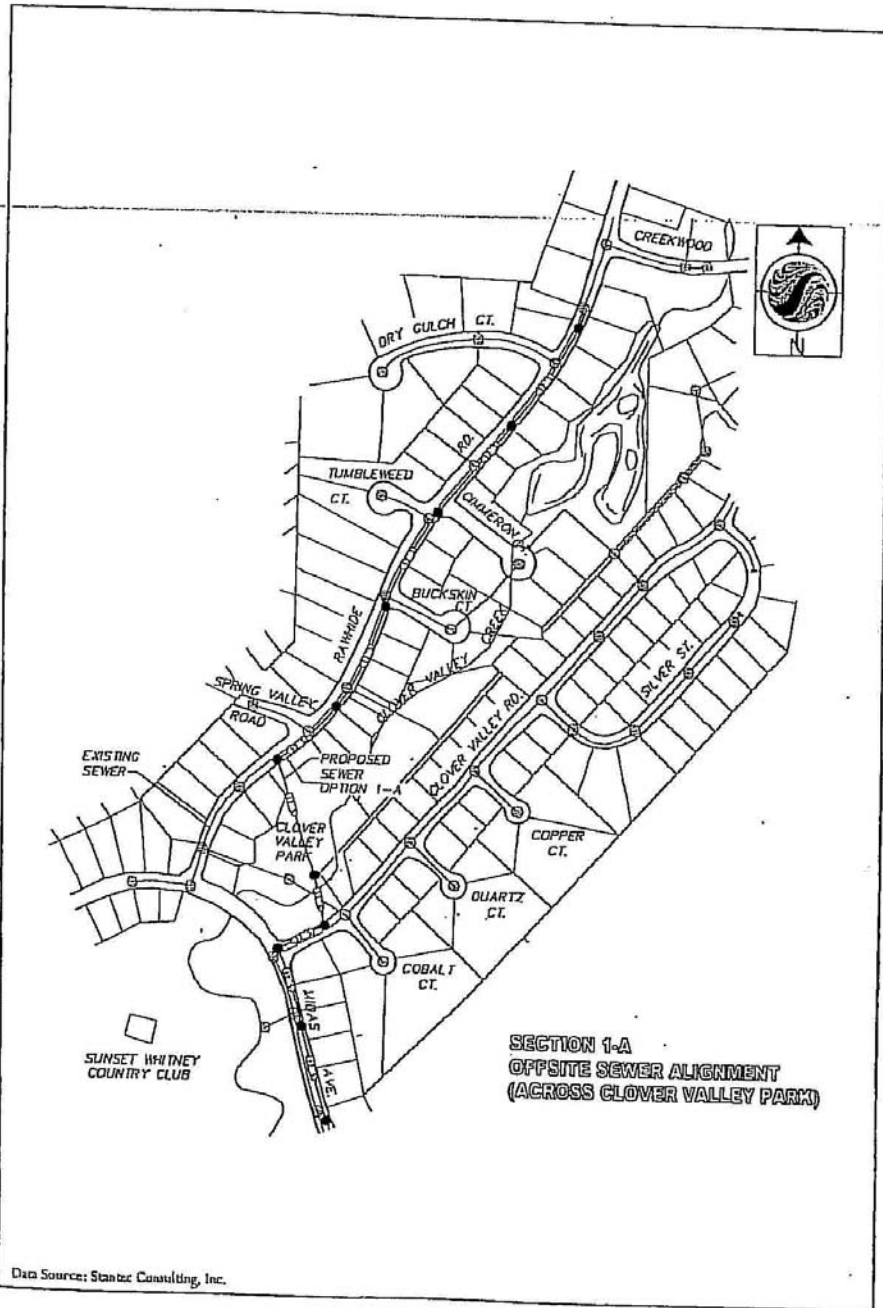

Figure 4.12 – 2

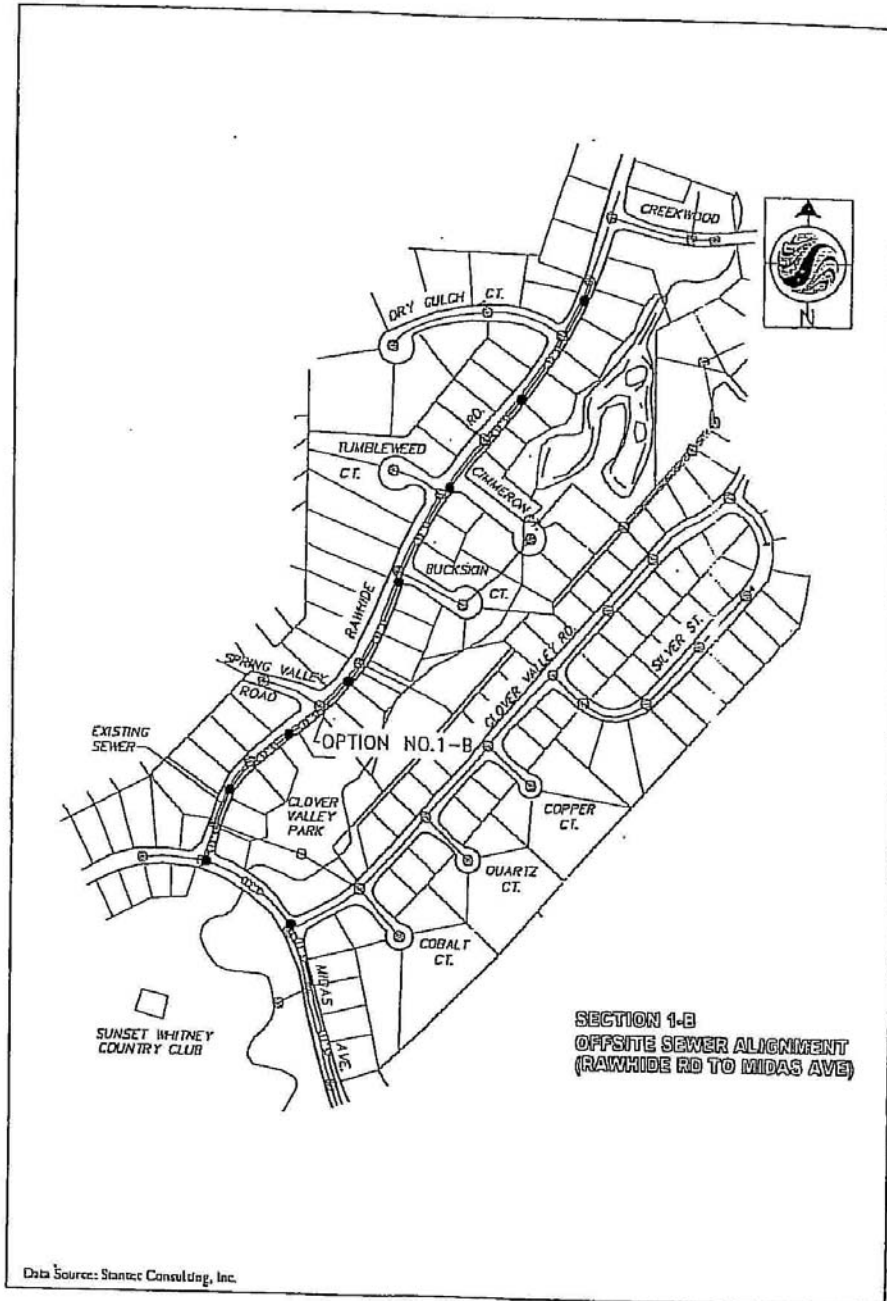

Figure 4.12 – 3

