

LAND USE SUMMARY

Site Area (Net) = 52.35 Acres (2,290,396 SF)

I. Retail Promenade

- Blkg A
- Blkg B
- Blkg C
- Blkg D
- Blkg E
- Blkg F
- Blkg G

Total Blkg SF not to exceed = 474,500K SF Building Area
 = 60,000K SF Garden Center Area

II. Village I

- Pad 5
- Pad 6
- Pad 7
- Pad 8
- Pad 9

Note: Pad average size = 4K - 7K SF
 Total Blkg SF not to exceed = 22,000K SF

III. Village II

- Pad 10
- Pad 11
- Pad 12
- Pad 13
- Pad 14

Note: Pad average size = 4K - 7K SF
 Total Blkg SF not to exceed = 24,600K SF

IV. Village III

- Pad 1
- Pad 2
- Pad 3
- Pad 4

Note: Pad average size = 4K - 7.5K SF
 Total Blkg SF not to exceed = 22,564K SF

Total Commercial Building Area 483,600 SF
Total Garden Center 60,000 SF
Land to Blkg. Ratio 3:19:1

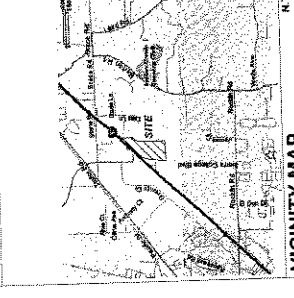

PARKING SUMMARY

PARKING REQUIRED	2,479
COMMERCIAL BUILDING (Average 5 / 1,000 SF)	60
GARDEN CENTER (Average 1 / 1,000 SF)	2,419
TOTAL REQUIRED	2,479
PARKING PROVIDED	2,371
STANDARD	70
COMPACT	70
HANDICAP	29
CART CORNERS	29
TOTAL PROVIDED	2,353

Client: ARCHITECTS
 5000 14th Street
 Suite 205
 Rocklin, CA 95765
 (916) 221-4171 Fax
 (916) 221-4171 Phone
 www.architects.com

Architect: Park Architects
 200 E. Bay Street, Suite 100
 Costa Mesa, CA 92626
 (714) 442-2741 Fax
 email: parkarchitects.com

Engineer: Park Architects
 200 E. Bay Street, Suite 100
 Costa Mesa, CA 92626
 (714) 442-2741 Fax
 email: parkarchitects.com

Planner: Park Architects
 200 E. Bay Street, Suite 100
 Costa Mesa, CA 92626
 (714) 442-2741 Fax
 email: parkarchitects.com

Interior Designer: Park Architects
 200 E. Bay Street, Suite 100
 Costa Mesa, CA 92626
 (714) 442-2741 Fax
 email: parkarchitects.com

Signage Designer: Park Architects
 200 E. Bay Street, Suite 100
 Costa Mesa, CA 92626
 (714) 442-2741 Fax
 email: parkarchitects.com

Construction Manager: Park Architects
 200 E. Bay Street, Suite 100
 Costa Mesa, CA 92626
 (714) 442-2741 Fax
 email: parkarchitects.com

Construction Manager: Park Architects
 200 E. Bay Street, Suite 100
 Costa Mesa, CA 92626
 (714) 442-2741 Fax
 email: parkarchitects.com



3581 Truxel Road
Sacramento, CA

PR 24/08

SITE PLAN

DEF KLFER + ASSOCIATES
INCORPORATED
4757 J Street Sacramento, CA 95819 916/214726 Fax 916/214196

sheet title
SITE PLAN

revisions

JOB	2404-07
DATE	Dec. 1, 2009
SCALE	NOTED
NOTED	

A1.1

sheet

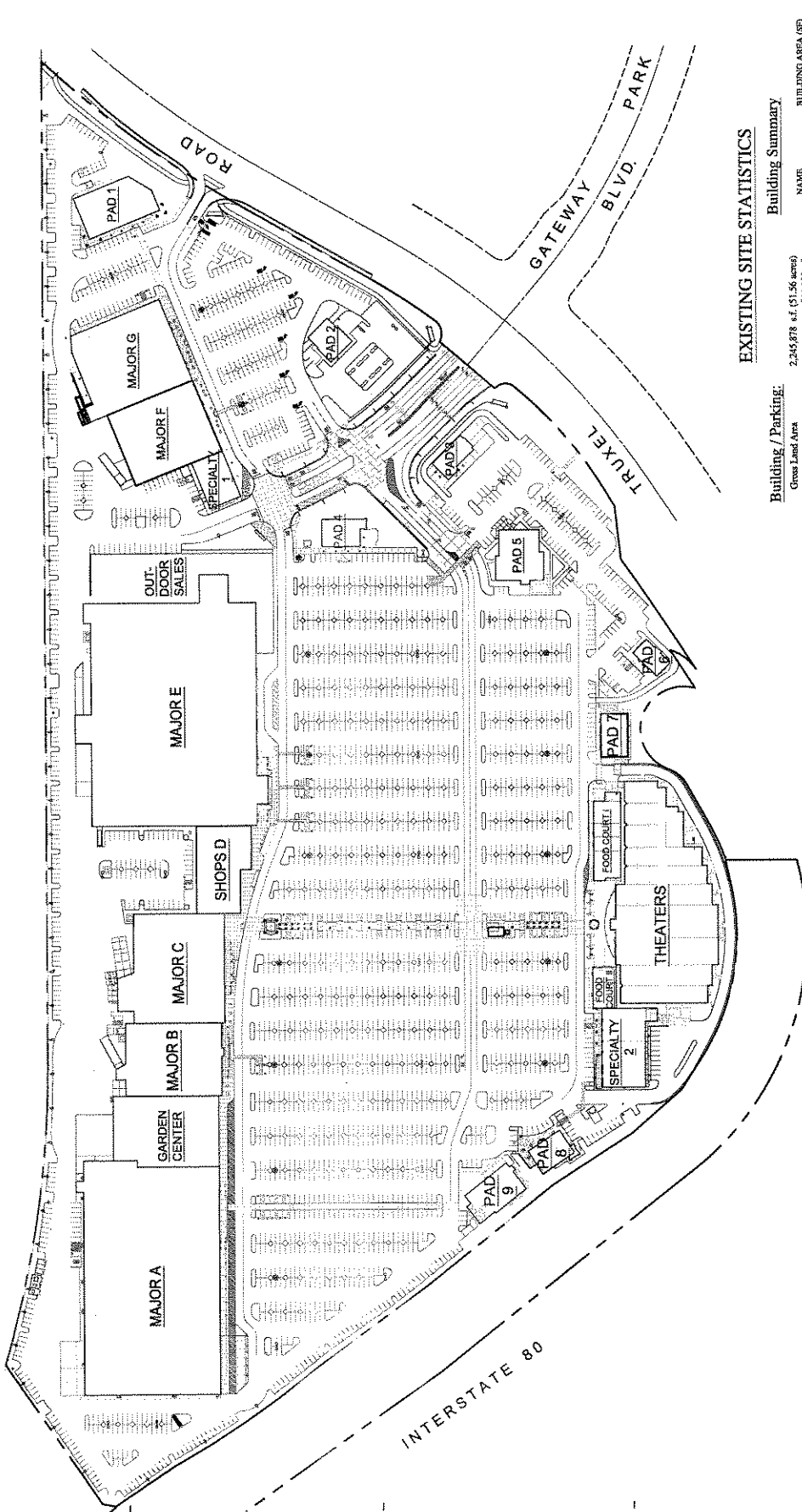

EXISTING SITE STATISTICS

NAME	BUILDING AREA (SF)
MAJOR A	185,000
MAJOR B	294,000
MAJOR C	24,200
MAJOR D	35,100
MAJOR E	129,800
MAJOR F	21,600
MAJOR G	23,600
OUTDOOR SALES	10,400
SPECIALTY 1	3,500
SPECIALTY 2	3,000
FOOD COURT I	6,500
FOOD COURT II	2,168
THEATERS	4,000
TOTAL	594,124 s.f.

Building / Parking:	Building Summary
Great Land Area	2,345,878 s.f. (51.26 acres)
Total Building Area	340,124 s.f.
Land-to-Bldg Ratio	3.33/1
Building Coverage	24.33%
Parking Required:	2,721 spaces
Parking Provided	2,815 spaces
Parking Ratio Required	5.0/1,000 s.f.
Parking Ratio Provided	5.17/1,000 s.f.

Parking Types:	Sub-totals
Standard stalls (9'x19')	2,728 stalls
Compact stalls (6'x16')	70 stalls
Handicap stalls (14'x18' / 17'x18')	67 stalls
Sub-total	2,815 stalls