

ANDREGG, INC.

SURVEYING • MAPPING • GEOMATICS

STATION DESCRIPTION & SKETCH

JN 11559-00 Project Name: City of Rocklin Control Network

QUADRANGLE NAME: Rocklin STATION NAME: RM 119 (RS-S)

Approximate Latitude: 38° 47' 18.90" Approximate Longitude: 121° 13' 13.66"

Described by: 38° 47' 19.25" N Date: 121° 13' 9.83" W

To reach the point FROM INTERSECTION OF ROCKLIN ROAD & EAST BOUND I-80 ON OFF RAMP 200'± EAST ALONG THE NORTH SIDE OF ROCKLIN RD TO SECRET RAVINE BRIDGE TOP OF WEST END OF NORTH RAIL & MONUMENT

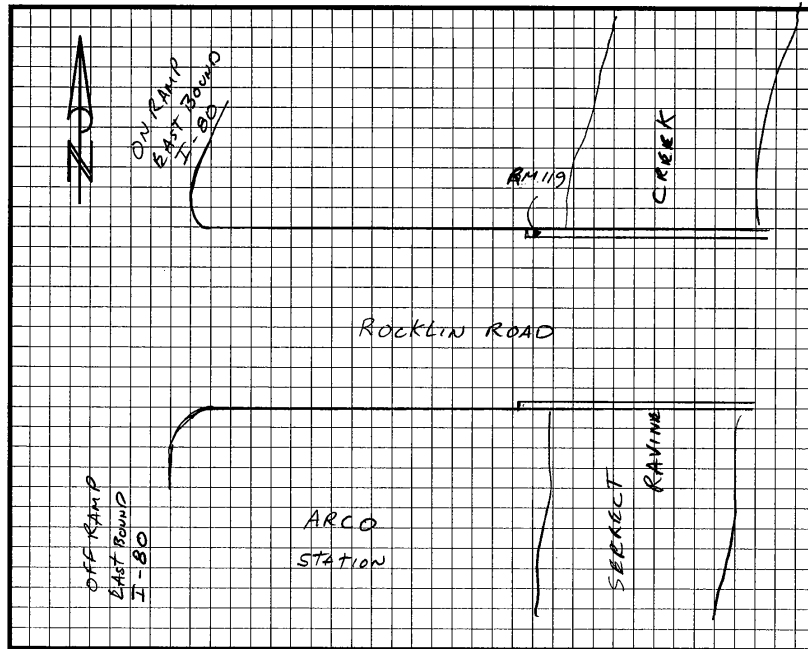

The point is marked by PK & ANDREGG, INC WASHER and is 2'± ABOVE the ground.

