

200 H-7

# ANDREGG, INC.

SURVEYING • MAPPING • GEOMATICS

## STATION DESCRIPTION & SKETCH

JN 11559-00 - Project Name: City of Rocklin Control Network

QUADRANGLE NAME: \_\_\_\_\_ STATION NAME: D 830 ? (R-1-9)

Approximate Latitude: 38° 48' 41.78" Approximate Longitude: 121° 12' 26.47"

Described by: \_\_\_\_\_ Date: \_\_\_\_\_

To reach the point FROM INTERSECTION OF SIERRA COLLEGE BLVD & PACIFIC ST NORTH TO RR TRACKS SOUTHWESTARLY ALONG RR TRACKS 400'± TO HEAD WALL ON SOUTH SIDE OF TRACKS NEAR NW CORNER OF POLE BARN

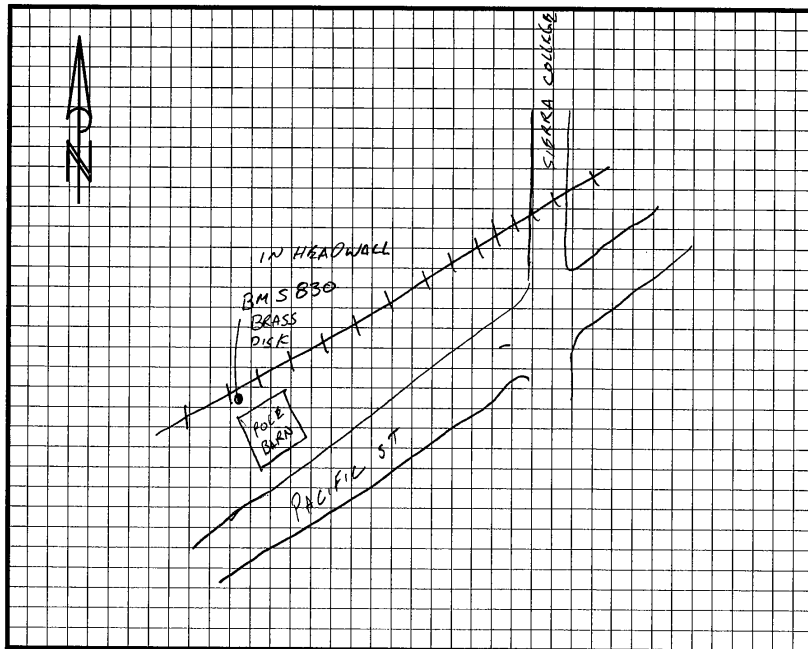

The point is marked by \_\_\_\_\_ and is \_\_\_\_\_ the ground.

UNABLE TO DISTINGUISH MARKINGS

