

ANDREGG, INC.

SURVEYING • MAPPING • GEOMATICS

220 D-4

STATION DESCRIPTION & SKETCH

JN 11559-00 Project Name: City of Rocklin Control Network

QUADRANGLE NAME: Roseville STATION NAME: D-13-HV-11 (R 8-2)

Approximate Latitude: 38°46'56.97" N Approximate Longitude: 121°14'33.9 W

Described by: D. REMINGTON Date: 1-8-03

To reach the point is in central island of sunset Blvd over J.P. RAILROAD TRACKS

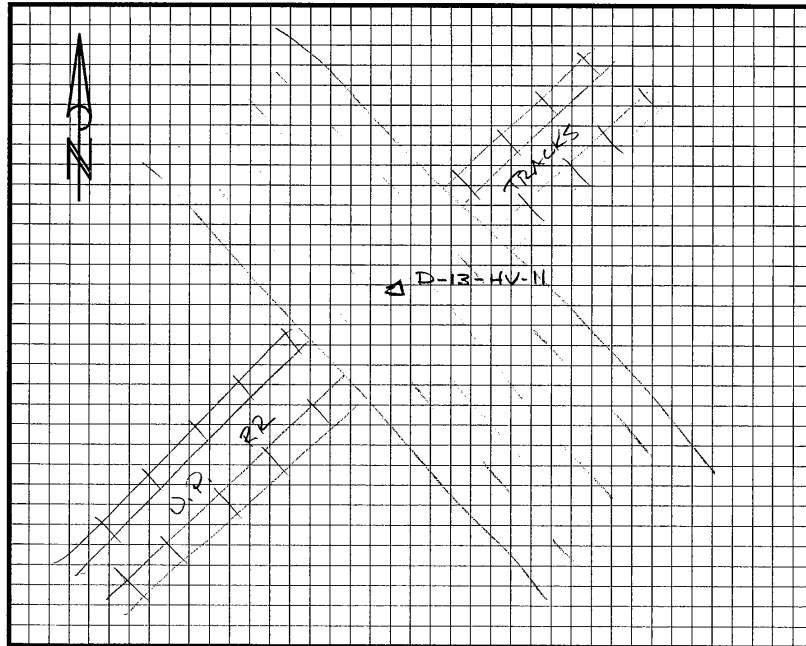

The point is marked by Copperweld Monument and is Flush with the ground.

